



SPECIFICATIONS

RATING : 100mA max, 42 VAC/DC
MECHANICAL LIFE : 1,000,000 cycles
CONTACT RESISTANCE : 100mΩ max.(initial)
INSULATION RESISTANCE : 1000MΩ min.
DIELECTRIC STRENGTH : 1,000 VAC

MATERIALS

SWITCH HOUSING : PBT
TRANSPARENT : PC
CONTACT : Stainless,Au version Ni-plated
TERMINALS : Brass,Au version Ni-plated
TERMINAL SEAL : Epoxy

HOW TO ORDER

MODEL NO. SIZE TYPE CAP TYPE CAP COLOR LED Q'TY 1st SET LED COLOR 2nd SET LED COLOR CONTACT MATERIAL LED BRIGHTNESS



SIZE TYPE
 5 15x15mm
 9 19x19mm

CAP TYPE
 A0 Transparent Actuation
 B Actuator
 C O.H Actuator

LED Q'TY
 0 No LED
 1 One LED
 2 Two LEDs
 3 Three LEDs
 4 Four LEDs

See below

CONTACT MATERIAL
 R Gold

LED BRIGHTNESS
 A Super Brightness

CAP COLOR	
ITEM NO	COLOR
1	White
3	Red
5	Yellow
6	Green
7	Blue

LED COLOR	
ITEM NO	COLOR
0	Without LED
1	White
3	Red
5	Yellow
6	Green
7	Blue



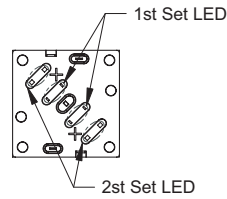
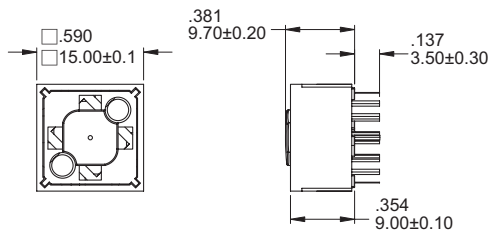

P.C. MOUNTING

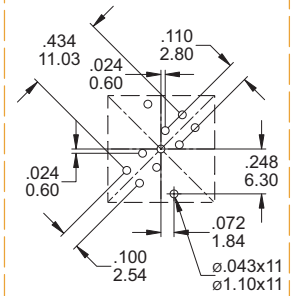

KS5A

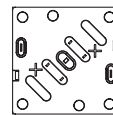
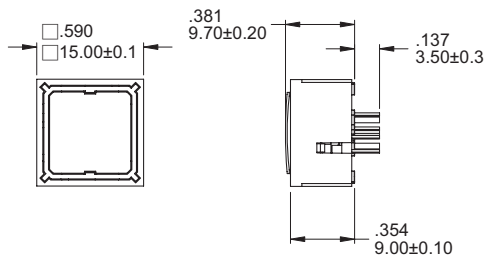

P.C. MOUNTING

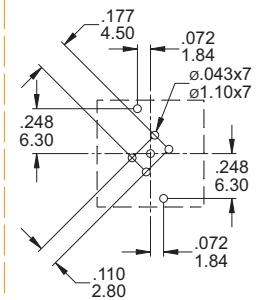

KS5B

KS
Key Switches

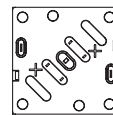
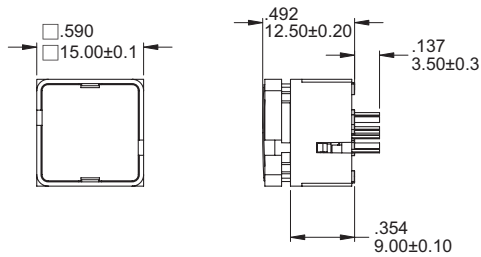

P.C. MOUNTING

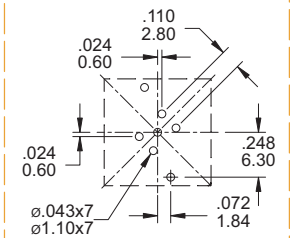

KS5C

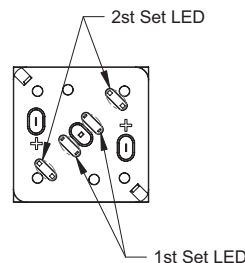
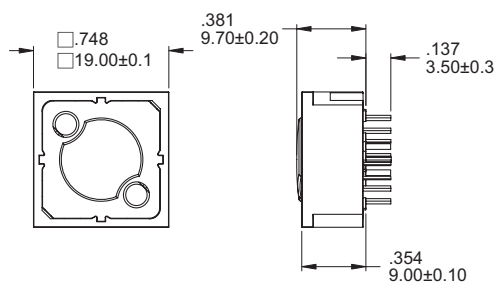

P.C. MOUNTING

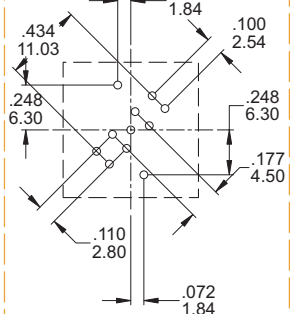

KS9A

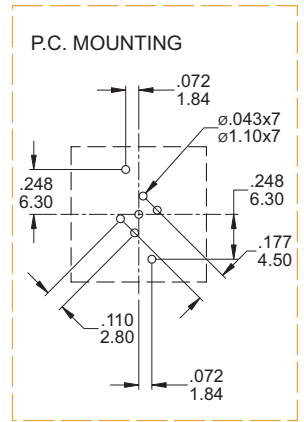
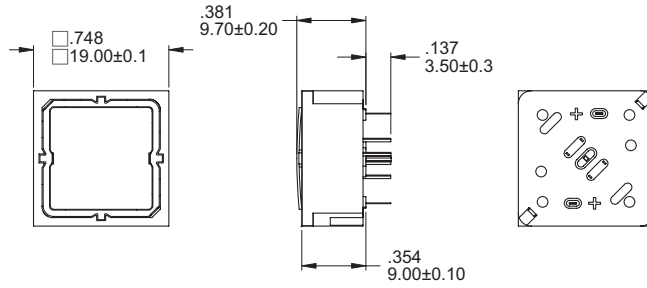

KS9B

LED CHARACTERISTICS

1st Set LED Color						Electro-potical Data			
Lens Color	LED Color	Dominant Wavelength	Test Condition	Peak Wavelength	Viewing Angle 2 θ 1/2(deg)	Vf (V)		Iv (Mcd)	
						Typ.	Max.	Typ.	Min.
Water Clear	White	x=0.27~0.31 y=0.27~0.31	IF = 5mA	—	165	2.8	3.3	40	32
	Red	λ d=638~648 nm	IF = 20mA	645	20	2.0	2.5	700	200
	Yellow	λ d=582~592 nm	IF = 20mA	595	20	2.0	2.5	1400	—
	Yellow Green	λ d=520 nm	IF = 20mA	565	20	2.2	2.7	130	80
	Blue	λ d=465~470 nm	IF = 20mA	460	20	3.1	3.6	580	250
2st Set LED Color						Electro-potical Data			
Lens Color	LED Color	Dominant Wavelength	Test Condition	Peak Wavelength	Viewing Angle 2 θ 1/2(deg)	Vf (V)		Iv (Mcd)	
						Typ.	Max.	Typ.	Min.
water diffused	Cool White	x=0.27~0.31 y=0.27~0.31	IF = 5mA	—	45	3.3	4.0	3300	2200
Red diffused	Super Bright Red	λ d=630 nm	IF = 20mA	630	45	2.05	2.6	850	460
Yellow diffused	Super Bright Yellow	λ d=590 nm	IF = 20mA	590	40	2.0	2.6	500	220
Green diffused	Green	λ d=570 nm	IF = 20mA	575	40	2.0	2.6	150	63
Blue diffused	Super Bright Blue	λ d=470 nm	IF = 20mA	468	45	3.5	3.8	1300	690