

## SPECIFICATIONS

**CONTACT RATING:** Dependent upon contact material.

**MECHANICAL LIFE:** 30,000 make-and-break cycles.

**CONTACT RESISTANCE:** 20mΩ max. initial @ 2-4VDC

100mA for both silver and gold plated contacts.

**INSULATION RESISTANCE:** 1,000MΩ min.

**DIELECTRIC STRENGTH:** 1,000 V RMS@sea level.

**OPERATING TEMPERATURE:** -30°C to 85°C.

## MATERIALS

**CASE:** Diallyl phthalate (DAP) (UL94v-0).

**HOUSING:** Brass,tin plated.

**ACTUATOR:** Nylon,black.

**CONTACT:** Silver or gold plated.

**TERMINAL SEAL:** Copper alloy,with silver and gold plated .

(See Page 97)

## HOW TO ORDER

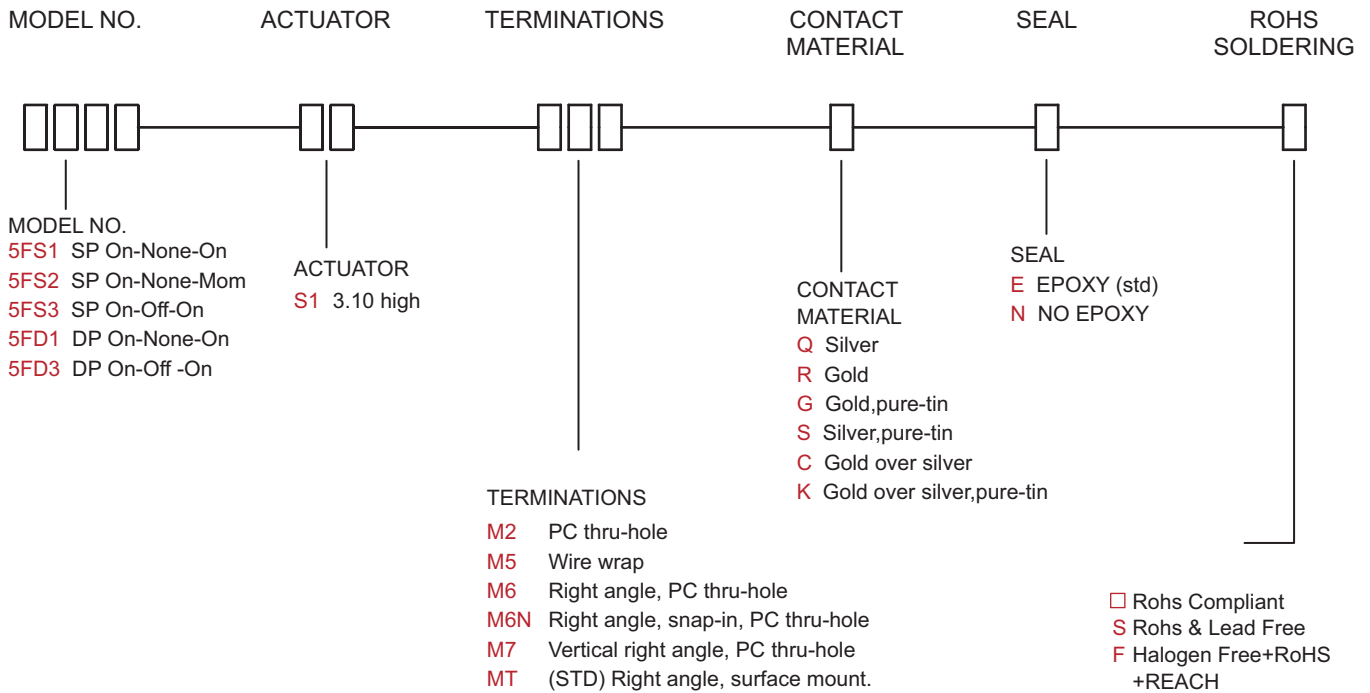

## SWITCH FUNCTION

NO. POLES	UL/CSA MODEL NO.	MODEL NO.	SWITCH FUNCTION			CONNECTED TERMINALS / SCHEMATIC		
			POS.1	POS.2	POS.3	POS.1	POS.2	POS.3
SP	Q2511	5FS1	ON	NONE	ON	2-1	N/A	2-3
	Q2513	5FS3	ON	OFF	ON	2 (COMM) 1 • 3	OPEN	2 (COMM) 1 • 3
DP	Q2521	5FD1	ON	NONE	ON	2-1,5-4	N/A	2-3,5-6
	Q2523	5FD3	ON	OFF	ON	2 (COMM) 5 1 • 3 4 • 6	OPEN	2 (COMM) 5 1 • 3 4 • 6

MOM=MOMENTARY

## POLE OPTIONS

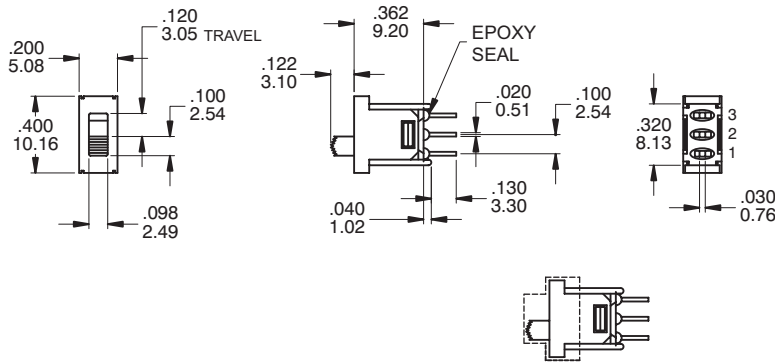

P.C. MOUNTING

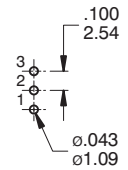

SPDT

Part No. Shown : 5FS1S102M2QE

Waterproof transparent cover

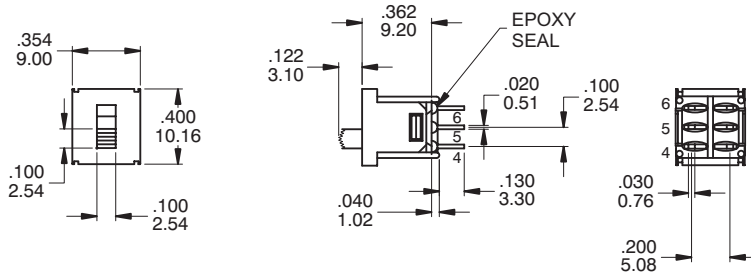

P.C. MOUNTING

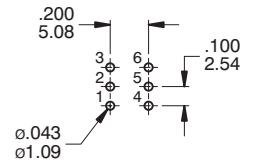

DPDT

Part No. Shown : 5FD1S102M2QE

## TERMINATION OPTIONS

M2 PC THRU-HOLE

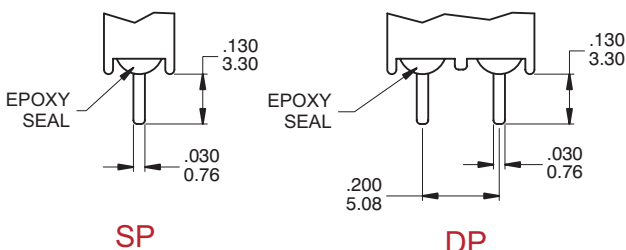

OTHER TERMINATION OPTIONS

- M6 RIGHT ANGLE P.C. MOUNT
- M6N SNAP - IN RIGHT ANGLE P.C. MOUNT

# Sub-Miniature Slide Switches **5F SERIES**

**M6**

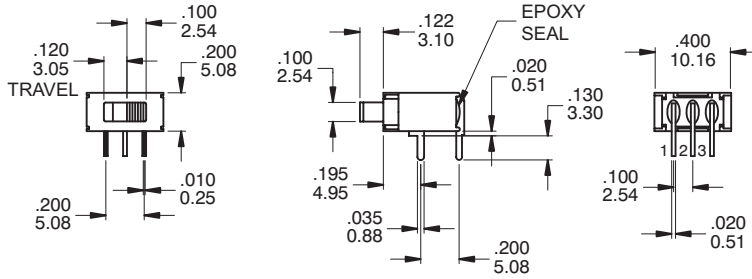
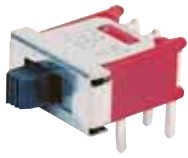

P.C. MOUNTING

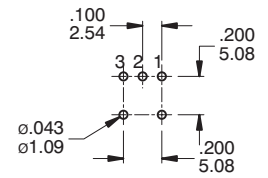

**SPDT**

Part No. Shown : 5FS1S102M6QE

**M6**

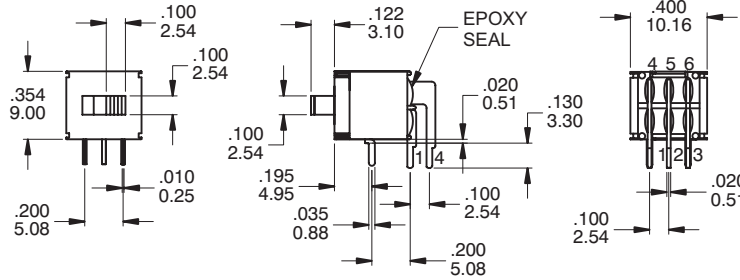
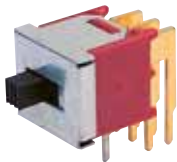

P.C. MOUNTING

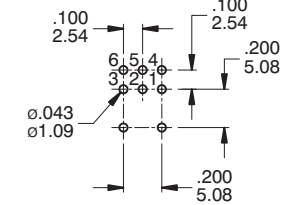

**DPDT**

Part No. Shown : 5FD1S102M6QE

**MZ**

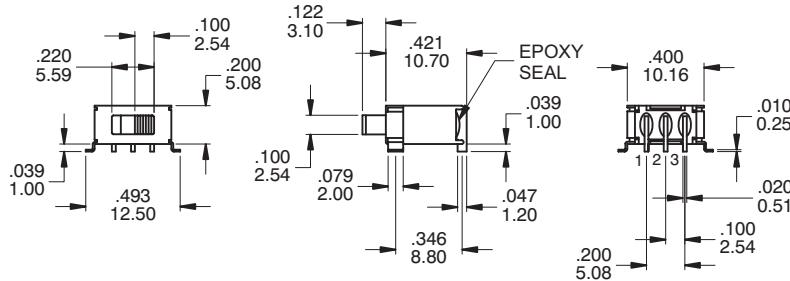

P.C. MOUNTING

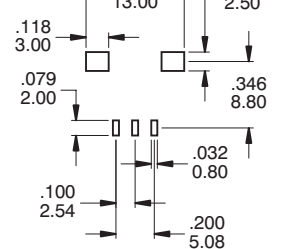

**SPDT**

Part No. Shown : 5FS1S102MZRES

**M7N**

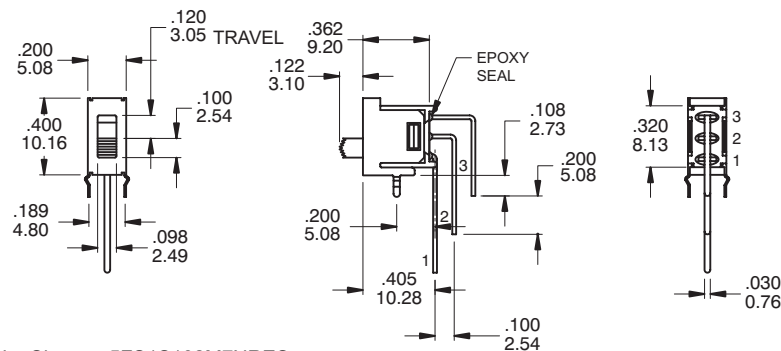

P.C. MOUNTING

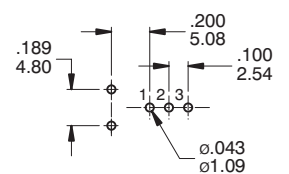

**SPDT**

Part No. Shown : 5FS1S102M7NRES

## SNAP-IN TERMINATION OPTIONS

**M6N**

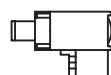

Slide Switches

**CONTACT MATERIAL OPTIONS**

	CONTACT MATERIAL	TERMINAL PLATING	RATINGS
Q	Silver	Q = Silver	3 Amps with resistant load @ 120VAC or 28VDC 1 Amps with resistant load @ 250VA
S		S = Silver,pure - tin	
C	Gold over Silver	C = Gold over silver	
K		K = Gold over silver,pure - tin	
R	Gold	R = Gold	0.4 Volt - Amps ( VA ) max. @ 20V max. ( AC or DC )
G		G = Gold,pure - tin	



**SOLDERING PROCESSES**

**MANUAL SOLDERING :** Use soldering iron of 30 watts, controlled st 350°C approximately 5 seconds while applying solder.

**WAVE SOLDERING :** Recommended Soldering Temperature : 260 ± 5°C  
Duration of Solder Immersion : 5 ± 1 seconds  
(PCB is 1.6mm in thickness)

**SOLDERING : Vapor phase**

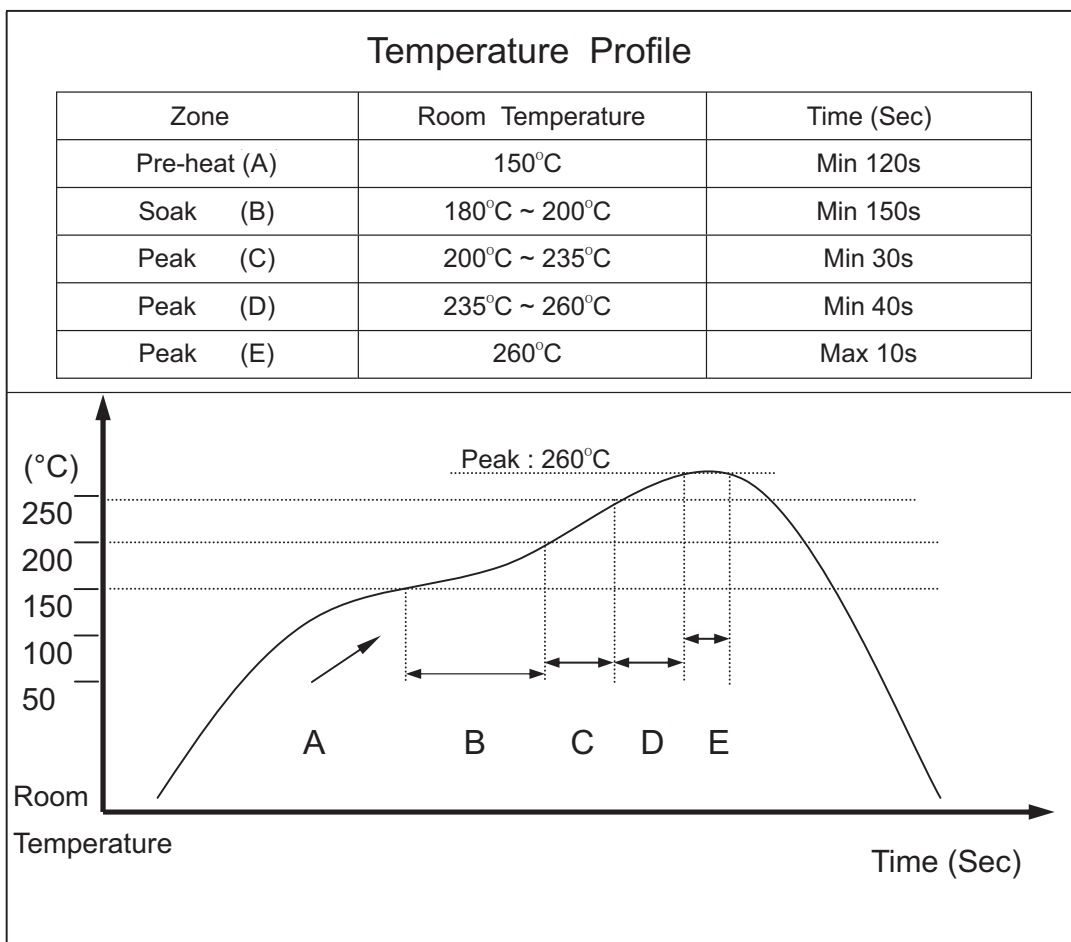

Slide Switches