

## SPECIFICATIONS

- CONTACT RATING:** Dependent upon contact material.
- MECHANICAL LIFE:** 30,000 make-and-break cycles.
- CONTACT RESISTANCE:** 20mΩ max. initial @ 2-4VDC  
100mA for both silver and gold plated contacts.
- INSULATION RESISTANCE:** 1,000MΩ min.
- DIELECTRIC STRENGTH:** 1,000 V RMS@sea level.
- OPERATING TEMPERATURE:** -30°C to 85°C.

## MATERIALS

- CASE & BUSHING :** Glass filled nylon 6/6, flame retardant, heat stabilized (UL94V-0).
- ACTUATOR:** Nylon, black std. Internal O-ring seal standard with all actuators.
- SWITCH SUPPORT:** Brass or steel, tin plated.
- TERMINAL/CONTACT:** Silver or gold plated copper alloy. (See Page 79)

## HOW TO ORDER

MODEL NO.	ACTUATOR	FRAME COLOR	ACTUATOR COLOR	CAP MARKING	TERMINATIONS	TERMINAL MATERIAL	SEAL	ROHS SOLDERING																																																																																													
		<b>See below</b>																																																																																																			
<table border="0" style="width: 100%;"> <tr> <td style="width: 50px;">MODEL NO.</td> <td></td> </tr> <tr> <td>4AS1</td> <td>SP On-None-On</td> </tr> <tr> <td>4AS2</td> <td>SP On-None-Mom</td> </tr> <tr> <td>4AS3</td> <td>SP On-Off-On</td> </tr> <tr> <td>4AS4</td> <td>SP Mom-Off-Mom</td> </tr> <tr> <td>4AS5</td> <td>SP On-Off-Mom</td> </tr> <tr> <td>4AS6</td> <td>SP Off-None-On</td> </tr> <tr> <td>4AD1</td> <td>DP On-None-On</td> </tr> <tr> <td>4AD2</td> <td>DP On-None-Mom</td> </tr> <tr> <td>4AD3</td> <td>DP On-Off -On</td> </tr> <tr> <td>4AD6</td> <td>DP On-On-On</td> </tr> </table>	MODEL NO.		4AS1	SP On-None-On	4AS2	SP On-None-Mom	4AS3	SP On-Off-On	4AS4	SP Mom-Off-Mom	4AS5	SP On-Off-Mom	4AS6	SP Off-None-On	4AD1	DP On-None-On	4AD2	DP On-None-Mom	4AD3	DP On-Off -On	4AD6	DP On-On-On	<table border="0" style="width: 100%;"> <tr> <td style="width: 50px;">ACTUATOR</td> <td></td> </tr> <tr> <td>R1</td> <td>(STD) Rocker, 7.62 wide</td> </tr> <tr> <td>R2</td> <td>(STD) Rocker, 5.84 wide</td> </tr> <tr> <td>R4</td> <td>(STD) Rocker, 5.80 wide</td> </tr> </table>	ACTUATOR		R1	(STD) Rocker, 7.62 wide	R2	(STD) Rocker, 5.84 wide	R4	(STD) Rocker, 5.80 wide		<table border="0" style="width: 100%;"> <tr> <td style="width: 50px;">CAP MARKING</td> <td></td> </tr> <tr> <td>1</td> <td></td> </tr> <tr> <td>2</td> <td></td> </tr> <tr> <td>5</td> <td></td> </tr> <tr> <td>6</td> <td></td> </tr> <tr> <td>7</td> <td></td> </tr> <tr> <td>8</td> <td></td> </tr> <tr> <td>9</td> <td></td> </tr> <tr> <td>F</td> <td></td> </tr> </table>	CAP MARKING		1		2		5		6		7		8		9		F		<table border="0" style="width: 100%;"> <tr> <td style="width: 50px;">TERMINATIONS</td> <td></td> </tr> <tr> <td>M1</td> <td>Solder Lug</td> </tr> <tr> <td>M2</td> <td>PC thru-hole</td> </tr> <tr> <td>M5</td> <td>wire wrap</td> </tr> <tr> <td>M6</td> <td>Right angle, PC thru-hole</td> </tr> <tr> <td>M6N</td> <td>Right angle, snap-in, PC thru-hole</td> </tr> <tr> <td>M7</td> <td>Vertical right angle, PC thru-hole</td> </tr> <tr> <td>M7N</td> <td>Vertical right angle, snap-in, PC thru-hole</td> </tr> <tr> <td>VS2</td> <td>8.94 high, V-bracket</td> </tr> <tr> <td>V2N</td> <td>8.94 high, snap-in V-bracket</td> </tr> </table>	TERMINATIONS		M1	Solder Lug	M2	PC thru-hole	M5	wire wrap	M6	Right angle, PC thru-hole	M6N	Right angle, snap-in, PC thru-hole	M7	Vertical right angle, PC thru-hole	M7N	Vertical right angle, snap-in, PC thru-hole	VS2	8.94 high, V-bracket	V2N	8.94 high, snap-in V-bracket	<table border="0" style="width: 100%;"> <tr> <td style="width: 50px;">TERMINAL MATERIAL</td> <td></td> </tr> <tr> <td>Q</td> <td>Silver</td> </tr> <tr> <td>R</td> <td>Gold</td> </tr> <tr> <td>G</td> <td>Gold, pure-tin</td> </tr> <tr> <td>S</td> <td>Silver, pure-tin</td> </tr> <tr> <td>C</td> <td>Gold over silver</td> </tr> <tr> <td>K</td> <td>Gold over silver, pure-tin</td> </tr> </table>	TERMINAL MATERIAL		Q	Silver	R	Gold	G	Gold, pure-tin	S	Silver, pure-tin	C	Gold over silver	K	Gold over silver, pure-tin	<table border="0" style="width: 100%;"> <tr> <td style="width: 50px;">SEAL</td> <td></td> </tr> <tr> <td>E</td> <td>EPOXY (std)</td> </tr> </table>	SEAL		E	EPOXY (std)	<table border="0" style="width: 100%;"> <tr> <td style="width: 50px;">ROHS SOLDERING</td> <td></td> </tr> <tr> <td><input type="checkbox"/></td> <td>Rohs Compliant</td> </tr> <tr> <td>S</td> <td>Rohs &amp; Lead Free</td> </tr> <tr> <td>F</td> <td>Halogen Free+RoHS +REACH</td> </tr> </table>	ROHS SOLDERING		<input type="checkbox"/>	Rohs Compliant	S	Rohs & Lead Free	F	Halogen Free+RoHS +REACH
MODEL NO.																																																																																																					
4AS1	SP On-None-On																																																																																																				
4AS2	SP On-None-Mom																																																																																																				
4AS3	SP On-Off-On																																																																																																				
4AS4	SP Mom-Off-Mom																																																																																																				
4AS5	SP On-Off-Mom																																																																																																				
4AS6	SP Off-None-On																																																																																																				
4AD1	DP On-None-On																																																																																																				
4AD2	DP On-None-Mom																																																																																																				
4AD3	DP On-Off -On																																																																																																				
4AD6	DP On-On-On																																																																																																				
ACTUATOR																																																																																																					
R1	(STD) Rocker, 7.62 wide																																																																																																				
R2	(STD) Rocker, 5.84 wide																																																																																																				
R4	(STD) Rocker, 5.80 wide																																																																																																				
CAP MARKING																																																																																																					
1																																																																																																					
2																																																																																																					
5																																																																																																					
6																																																																																																					
7																																																																																																					
8																																																																																																					
9																																																																																																					
F																																																																																																					
TERMINATIONS																																																																																																					
M1	Solder Lug																																																																																																				
M2	PC thru-hole																																																																																																				
M5	wire wrap																																																																																																				
M6	Right angle, PC thru-hole																																																																																																				
M6N	Right angle, snap-in, PC thru-hole																																																																																																				
M7	Vertical right angle, PC thru-hole																																																																																																				
M7N	Vertical right angle, snap-in, PC thru-hole																																																																																																				
VS2	8.94 high, V-bracket																																																																																																				
V2N	8.94 high, snap-in V-bracket																																																																																																				
TERMINAL MATERIAL																																																																																																					
Q	Silver																																																																																																				
R	Gold																																																																																																				
G	Gold, pure-tin																																																																																																				
S	Silver, pure-tin																																																																																																				
C	Gold over silver																																																																																																				
K	Gold over silver, pure-tin																																																																																																				
SEAL																																																																																																					
E	EPOXY (std)																																																																																																				
ROHS SOLDERING																																																																																																					
<input type="checkbox"/>	Rohs Compliant																																																																																																				
S	Rohs & Lead Free																																																																																																				
F	Halogen Free+RoHS +REACH																																																																																																				
			<b>See below</b>																																																																																																		
			<b>ACTUATOR COLOR</b>																																																																																																		
			<b>See below</b>																																																																																																		

ITEM NO	COLOR
1	White
2	Black (Std)
3	Red
4	Orange
5	Yellow
6	Green
7	Blue
8	Brown
9	Gray

## SWITCH FUNCTION

NO. POLES	UL/CSA MODEL NO.	MODEL NO.	SWITCH FUNCTION			CONNECTED TERMINALS / SCHEMATIC		
			POS.1	POS.2	POS.3	POS.1	POS.2	POS.3
SP	Q24A11	4AS1	ON	NONE	ON	2-3	N/A	2-1
	Q24A12	4AS2	ON	NONE	MOM			
	Q24A13	4AS3	ON	OFF	ON		OPEN	
	Q24A14	4AS4	MOM	OFF	MOM			
	Q24A15	4AS5	ON	OFF	MOM	OPEN	N/A	3-1
	Q24A16	4AS6	OFF	NONE	ON			
DP	Q24A21	4AD1	ON	NONE	ON	2-3,5-6	N/A	2-1,5-4
	Q24A22	4AD2	ON	NONE	MOM			
	Q24A23	4AD3	ON	OFF	ON		OPEN	
	Q24A26	4AD6	ON	ON	ON			

MOM=MOMENTARY

## POLE OPTIONS



SPDT

Part No. Shown : 4AS1R12M2RE

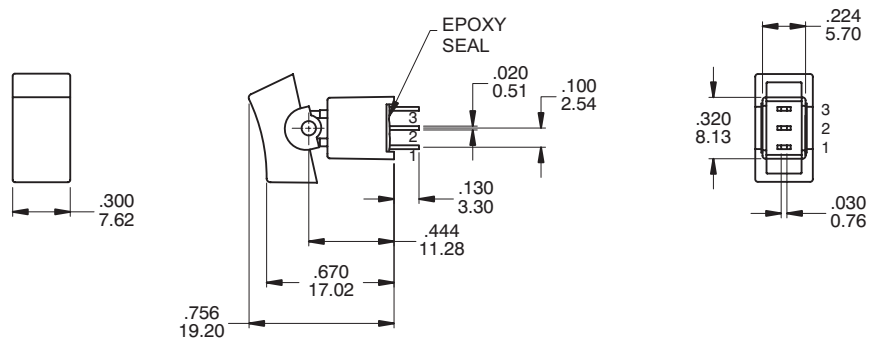

DPDT

Part No. Shown : 4AD1R12M2RE

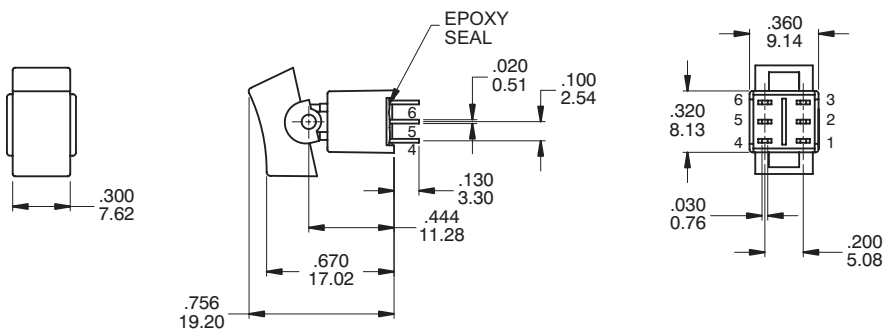

## ACTUATOR OPTIONS - PANEL MOUNT

R1

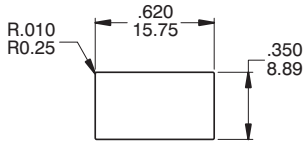

PANEL MOUNTING - R1

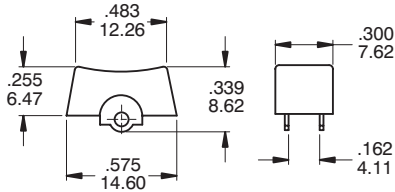

R2

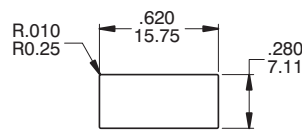

PANEL MOUNTING - R2

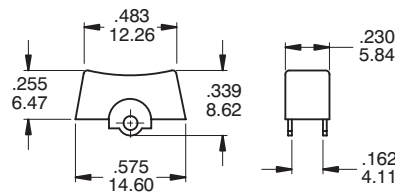

R4

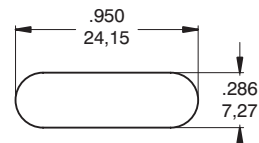

PANEL MOUNTING - R4

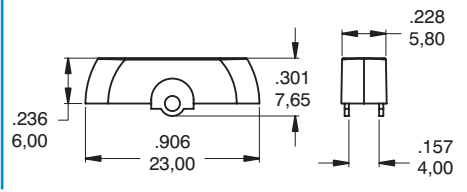

## TERMINATION OPTIONS

M2 P.C. MOUNT

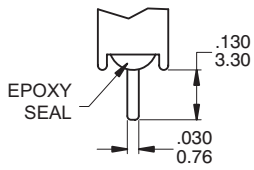

SP

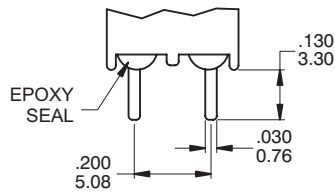

DP

M5 WIRE WEAP

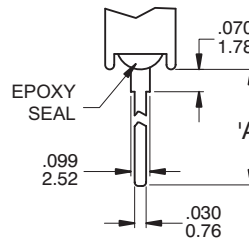

SP

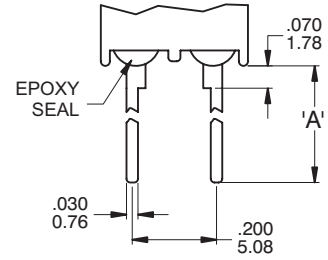

DP

### OTHER TERMINATION OPTIONS

- M6 RIGHT ANGLE P.C. MOUNT
- M7 RIGHT ANGLE P.C. MOUNT
- VS2 VERTICAL BRACKET P.C. MOUNT
- VS3 VERTICAL BRACKET P.C. MOUNT

OPTION CODE	DIM. 'A'
M5-1	.614 ( 15.60 )
M5-2	.236 ( 6.00 )

M6

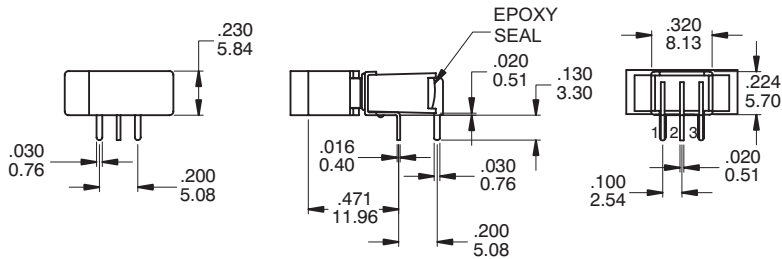

SPDT

Part No. Shown : 4AS1R22M6QE

P.C. MOUNTING

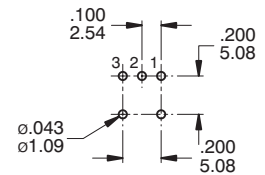

M6

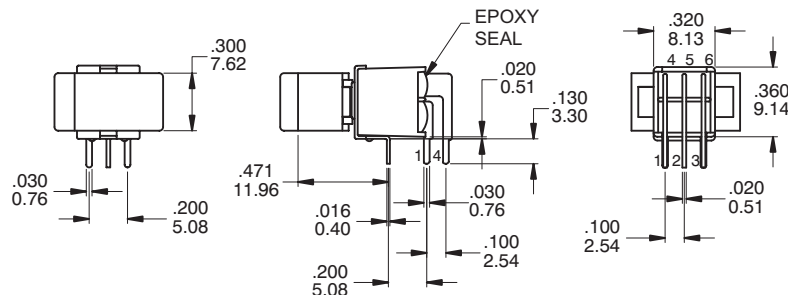

DPDT

Part No. Shown : 4AD1R12M6RE

P.C. MOUNTING

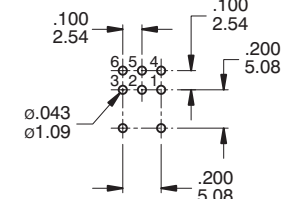

M7

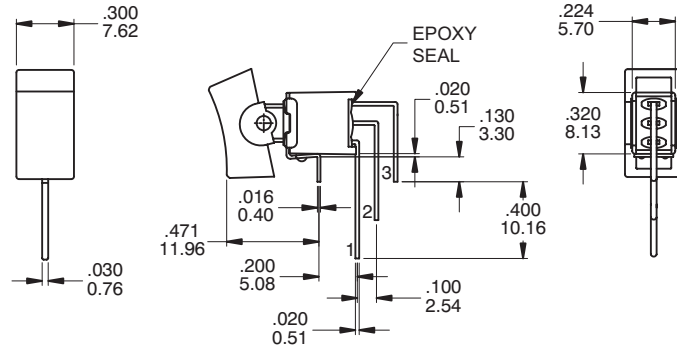

P.C. MOUNTING

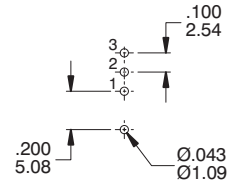

SPDT

Part No. Shown : 4AS1R12M7QE

M7

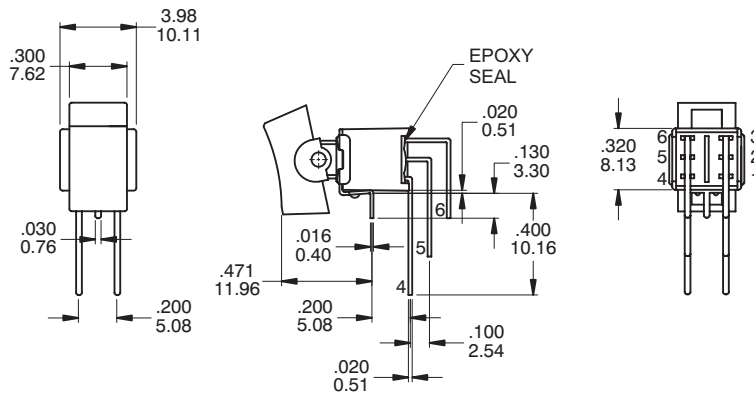

P.C. MOUNTING

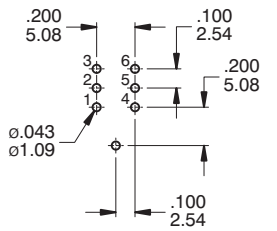

DPDT

Part No. Shown : 4AD1R12M7RE

VS2

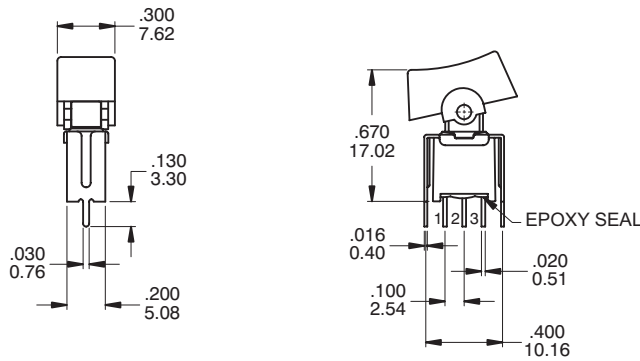

P.C. MOUNTING

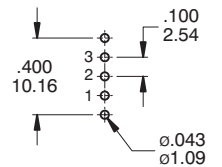

SPDT

Part No. Shown : 4AS1R12VS2RE

VS2

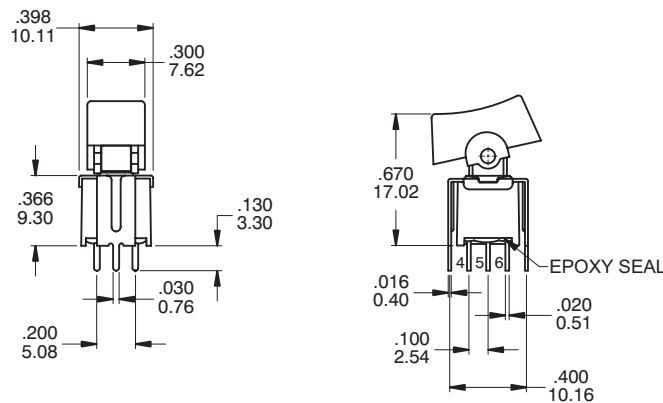

P.C. MOUNTING

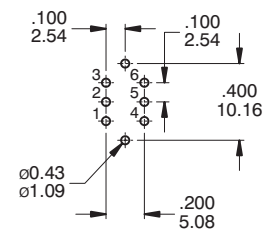

DPDT

Part No. Shown : 4AD1R12VS2RE

## SNAP-IM TERMINATION OPTIONS

M6N

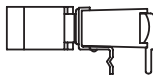
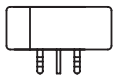

M7N

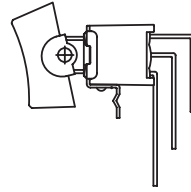
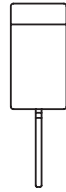

V2N

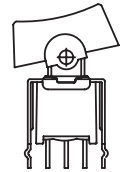
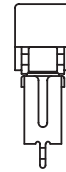

## CONTACT MATERIAL OPTIONS

	CONTACT MATERIAL	TERMINAL PLATING	RATINGS
Q	Silver	Q = Gold flash over silver	3 Amps with resistant load @ 120VAC or 28VDC 1 Amps with resistant load @ 250VA
S		S = Gold flash over silver,pure - tin	
C	Gold over Silver	C = Gold over silver	
K		K = Gold over silver,pure - tin	
R	Gold	R = Gold	0.4 Volt - Amps ( VA ) max. @ 20V max. ( AC or DC )
G		G = Gold,pure - tin	



IP 67  
ACCORDING TO  
EN 60529:1991+A1:2001  
IEC 60529:2001

### SOLDERING PROCESSES

**MANUAL SOLDERING :** Use soldering iron of 30 watts, controlled st 350°C approximately 5 seconds while applying solder.

**WAVE SOLDERING :** Recommended Soldering Temperature : 260 ± 5°C  
Duration of Solder Immersion : 5 ± 1 seconds  
(PCB is 1.6mm in thickness)

### SOLDERING : Vapor phase

#### Temperature Profile

Zone	Room Temperature	Time (Sec)
Pre-heat (A)	150°C	Min 120s
Soak (B)	180°C ~ 200°C	Min 150s
Peak (C)	200°C ~ 235°C	Min 30s
Peak (D)	235°C ~ 260°C	Min 40s
Peak (E)	260°C	Max 10s

